

FAG

6016-H-SN

Deep groove ball bearing

Schaeffler ID:
0949145160000Deep groove ball bearing 60..-H, single
row, H-Series, steel sheet metal cage

Technical information

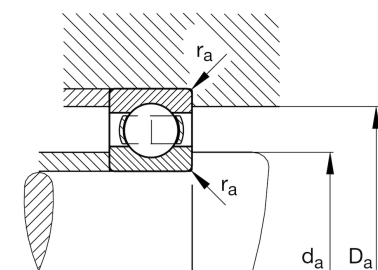
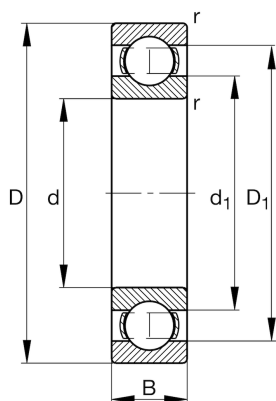
**Main Dimensions & Performance Data**

d	80 mm	Bore diameter
D	125 mm	Outside diameter
B	22 mm	Width
C_r	42.330 N	Basic dynamic load rating, radial
C_{0r}	35.640 N	Basic static load rating, radial
C_{ur}	2.190 N	Fatigue load limit, radial
n_G	7.500 1/min	Limiting speed
n_{gr}	6.200 1/min	Reference speed
	0,865 kg	Weight

Dimensions

r_{min}	1,1 mm	Minimum chamfer dimension
D_1	110,7 mm	Shoulder diameter outer ring
d_1	94,3 mm	Shoulder diameter inner ring

Mounting dimensions

$d_{a min}$	86 mm	Minimum diameter shaft shoulder
$D_{a max}$	119 mm	Maximum diameter of housing shoulder
$r_{a max}$	1 mm	Maximum fillet radius

Calculation factors

f_0	15,8	Calculation factor
-------	------	--------------------

Temperature range

T_{min}	-30 °C	Operating temperature min.
T_{max}	120 °C	Operating temperature max.